

3-5

Clinical Laboratory and Examination Center



Central Phlebotomy and Urinalysis Reception (2F)



Waiting Room 2 (1F)



Radiology Examination Reception Machine (1F)



After-Hours Consultation Reception (1F)



Radiotherapy Reception (B1F)

B1F

1F

2F

3F

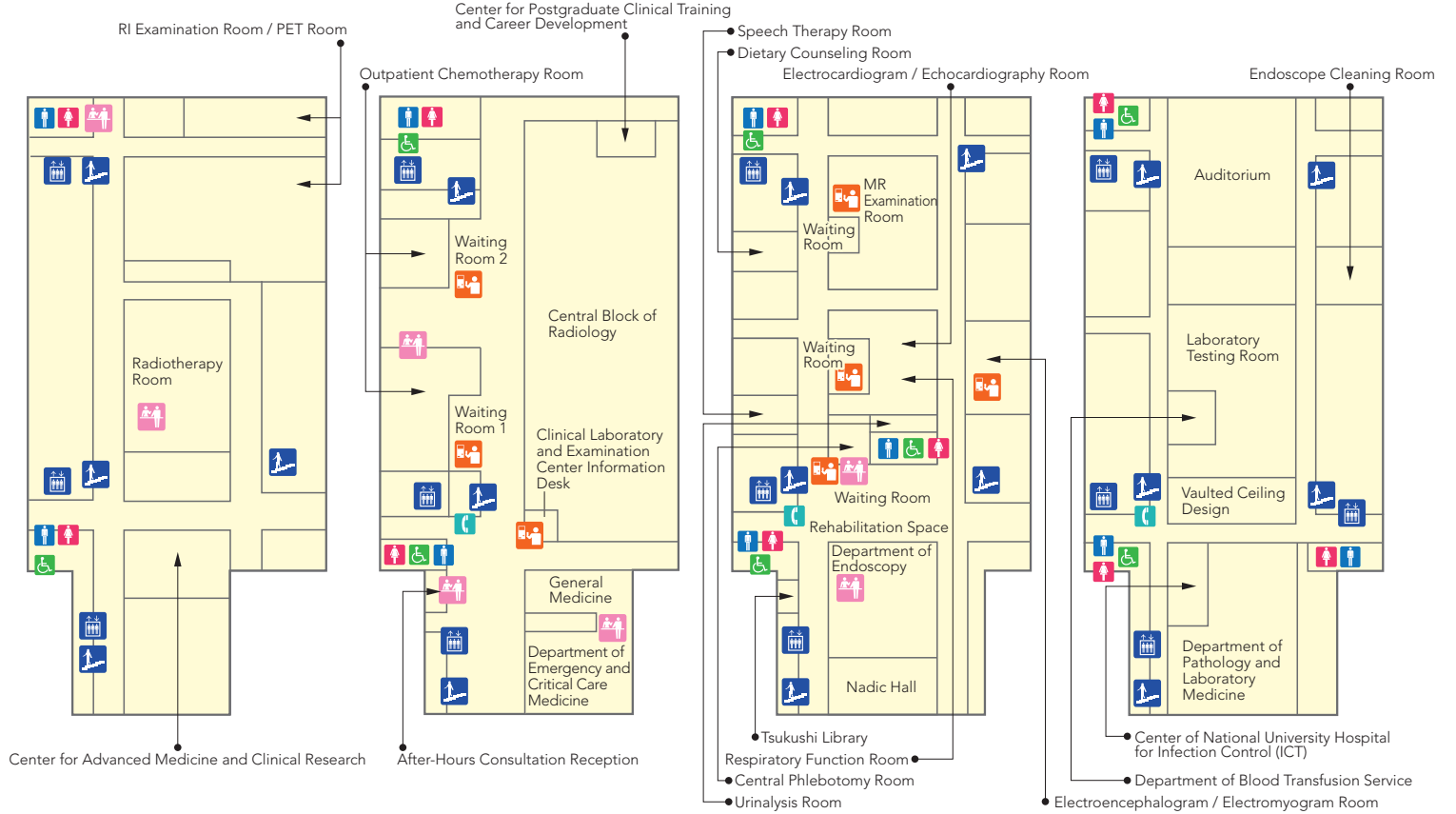

Clinical Laboratory and Examination Center Information Desk (1F)



4F

Center for Advanced Medicine and Clinical Research
 Department of Blood Purification (Dialysis Room)
 Space for General Medical Education

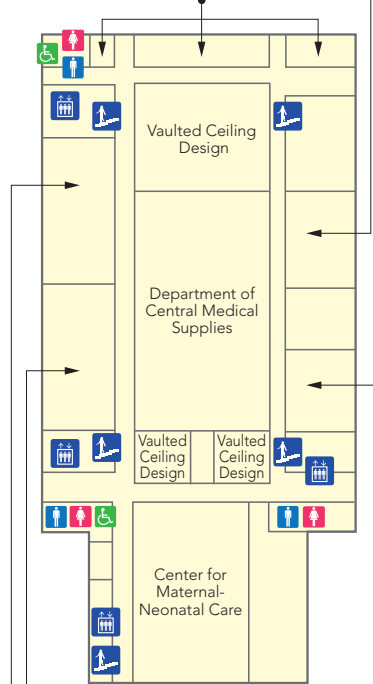

• Department of Clinical Engineering
 • Department of Quality and Patient Safety

5F

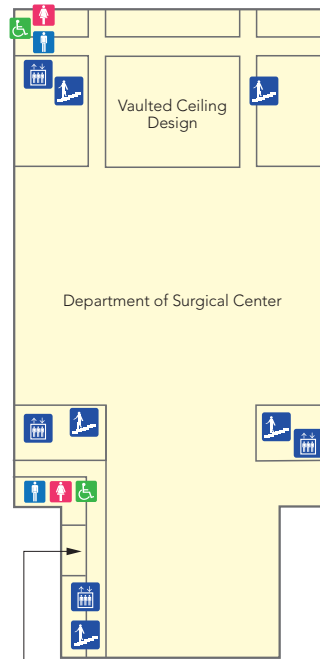

• Waiting Space for Family

6F

Center for Advanced Medicine and Clinical Research

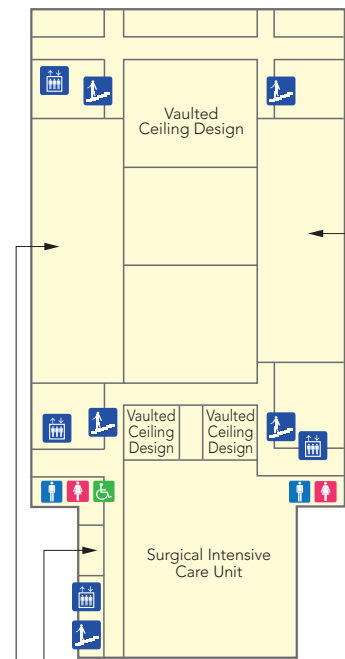

• Waiting Space for Family
 • Emergency and Medical Intensive Care Unit



Surgical Intensive Care Unit (6F)



Emergency and Medical Intensive Care Unit (6F)



Center for Maternal-Neonatal Care (4F)



Waiting Space for Family (5F)



Nadic Hall (2F)



Waiting Room/Rehabilitation Space (2F)

